

10,900 SF CORNER 2-STORY WAREHOUSE FOR SALE OR LEASE

24-26 47TH STREET, ASTORIA, NY 11103

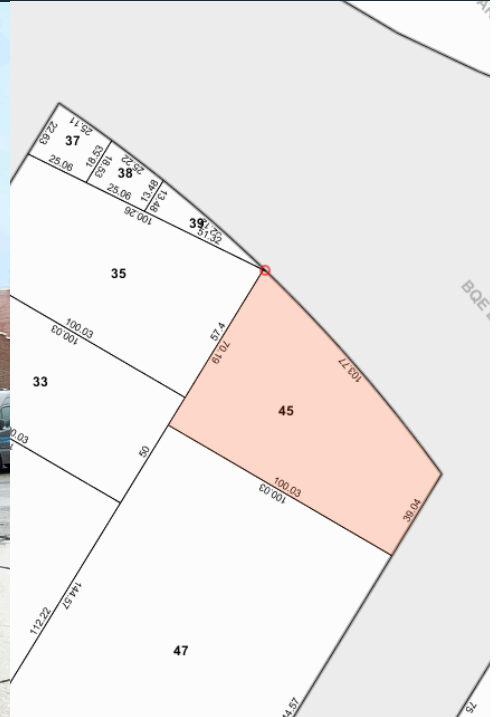

BLOCK/LOT	732 / 45
BUILDING DIMENSIONS	39 ft x 100 ft
BUILDING SIZE	10,900 SF
LOT DIMENSIONS	39.04 ft x 100.03 ft
LOT SIZE	5,465 SF
ZONING	M1-1
REAL ESTATE TAXES	\$43,873

DESCRIPTION

Greiner-Maltz is pleased to offer for sale or lease a two-story 10,900 SF warehouse in Astoria. Located on the corner of 47th Street and Brooklyn-Queens Expressway, this property is ideally situated to service all of NYC.

This opportunity is ideal for an owner-user.

FEATURES

- Heavy Power - 3000 Amps
- 1 Drive-In Door (13.5 ft)
- 14 ft Ceiling Heights
- Lots of Natural Light
- Sprinklered
- Great Traffic Exposure
- Convenient Location to Major Roadways

TRANSPORTATION

N W Subway
278 / Brooklyn Queens Expressway
Grand Central Parkway

EXCLUSIVE AGENT

MATTHEW MCMULLEN
(718) 786-5050
mmcmullen@greiner-maltz.com

GREINER-MALTZ
REAL ESTATE

Creating Opportunities Together
WWW.GREINER-MALTZ.COM

Any information set-forth herein has been obtained from sources deemed reliable, however, we have not verified it, and make no representation or warranty of any kind, including without limitation: condition: either latent or patent, size or manner of construction of the property, compliance with local law, and environmental conditions. All information submitted herein is subject to errors and omissions, and the right of our principal(s), to withdraw, modify, or condition the listing with-out prior notice. Broker cooperation encouraged.